

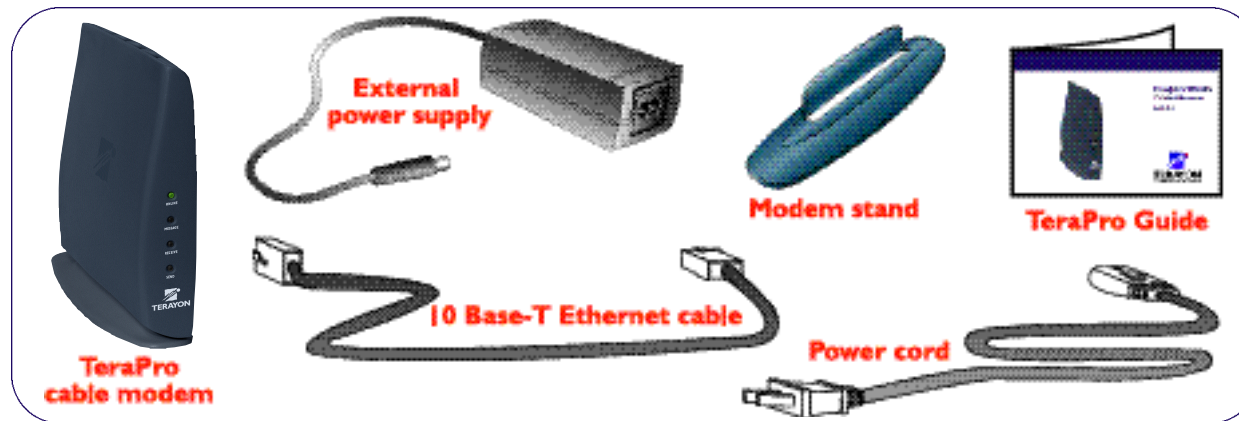

TeraPro Cable Modem Guide



Equipment List



Shipped with the TeraPro cable modem:

- External power cord with DC power cable
- AC power cord
- 10Base-T Ethernet cable
- TeraPro cable modem stand
- TeraPro cable modem guide

The other items you will need:

- Personal Computer (PC, Macintosh or other workstation computer) with Ethernet Network Interface Card (NIC)
- Straight 10Base-T Ethernet cable (non-retail packages)
- Communication software (provided by cable operator or ISP)

Getting Started

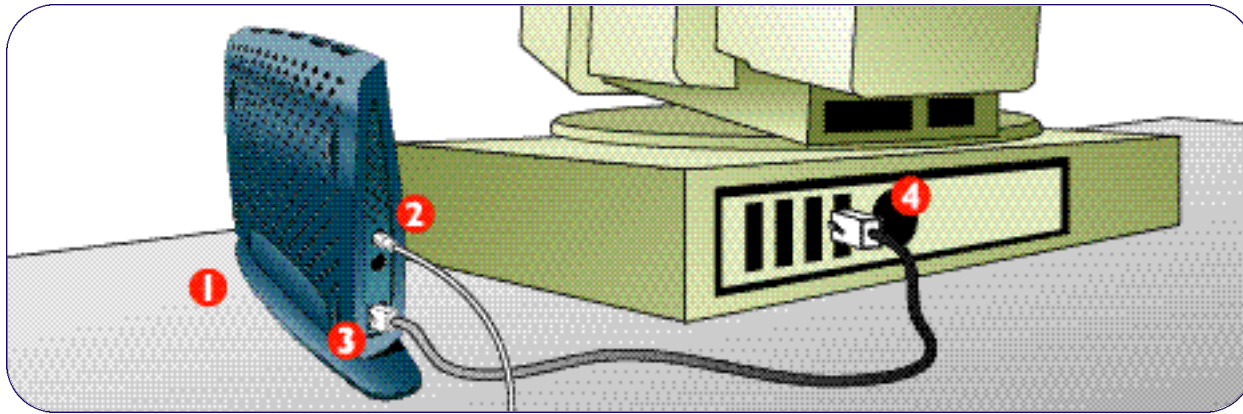

1. Place TeraPro cable modem on a sturdy, level surface near the computer.
2. Connect TV coaxial cable to the threaded connector on the back of TeraPro cable modem using F-type screw-on connector.
3. Insert the plug on one end of the 10Base-T Ethernet cable into the RJ-45 socket on the back of the TeraPro cable modem.
4. Insert the other end of the 10Base-T Ethernet cable into the RJ-45 socket at the back of the computer.

Getting Started *(continued)*

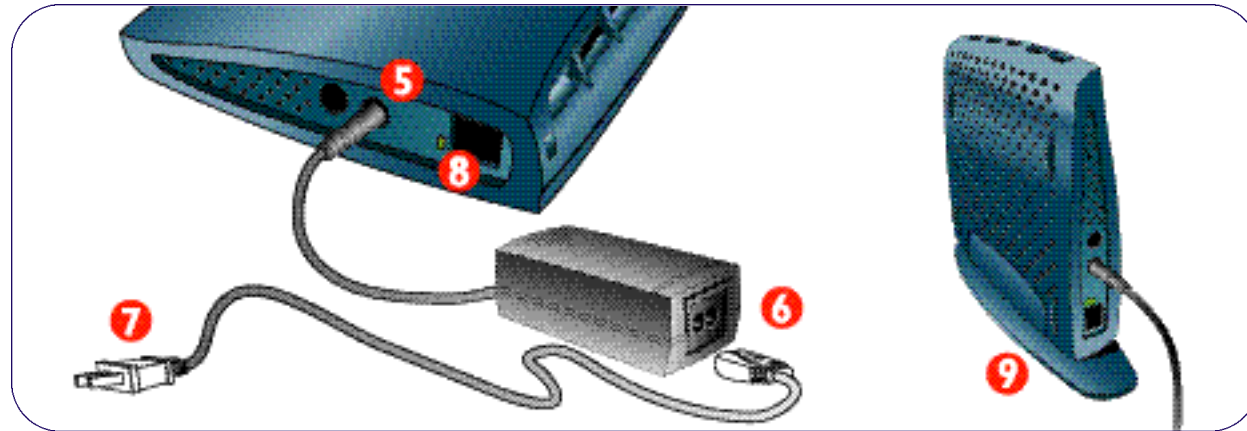

5. Insert the power supply DC cable connector into the power receptacle on the back of the modem.
6. Insert the AC power cord into the receptacle on the power supply.
7. Connect the AC power cord into an appropriate AC power outlet.
8. The link light on the back of the TeraPro cable modem should appear green, indicating a good connection to the personal computer or hub.
9. When using the modem stand, to ensure a good connection, insert the TeraPro cable modem as shown.

Turning Power Off

The TeraPro cable modem is designed to remain powered at all times. For optimal performance you should not turn off the TeraPro cable modem unless you are relocating the TeraPro cable modem or instructed to do so by your cable operator.

If you need to turn off the power to the TeraPro cable modem, pull the power cord from the AC power outlet in the wall.

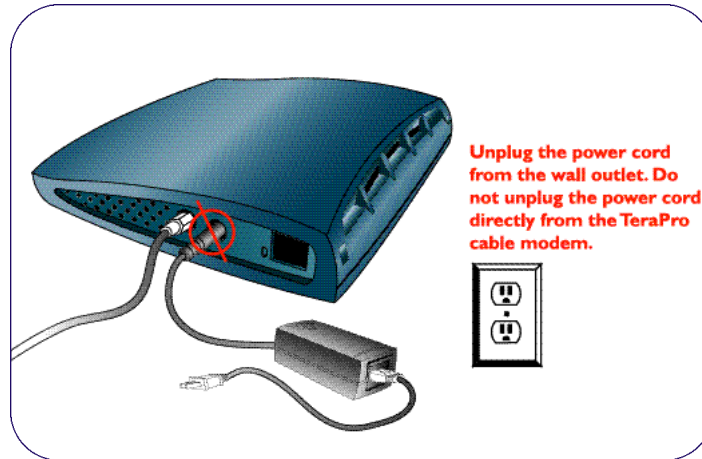

IMPORTANT

Unplug the power cord from the wall outlet. Do not unplug the power cord directly from the TeraPro cable modem.

Modem Power-Up LEDs

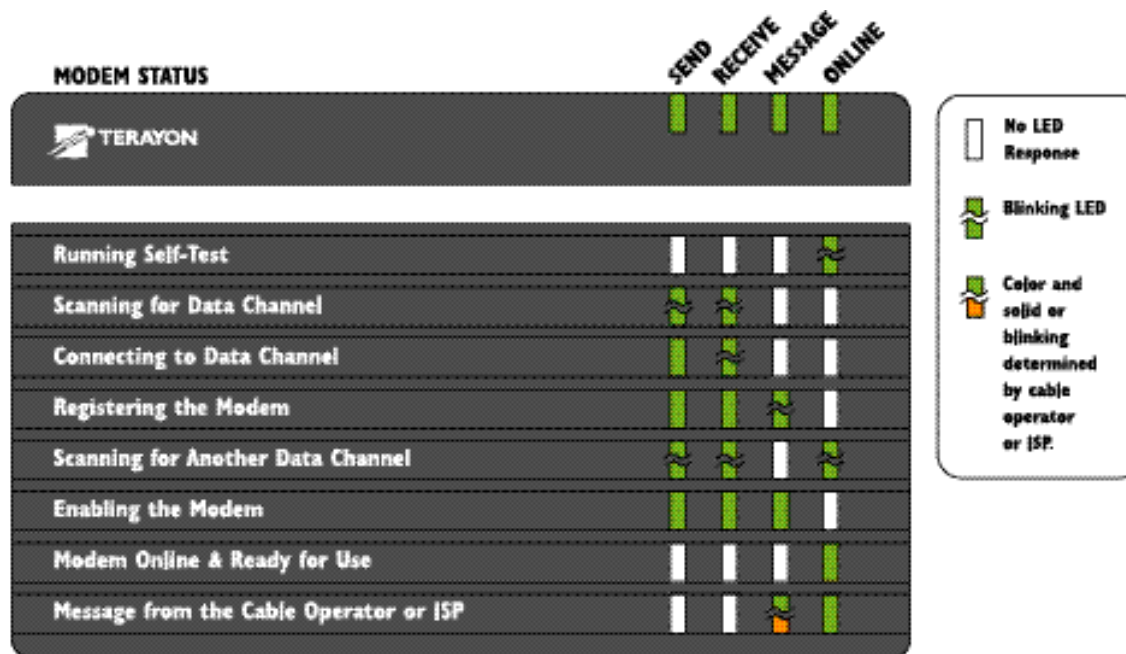

4

Please note: When you power on the TeraPro cable modem for the first time, it can take up to seven minutes for the Online LED to turn solid green. Do not power cycle the TeraPro cable modem as it cycles through the start up LED sequence, unless you are instructed to do so by your cable operator or ISP.

Please Note

Any modifications to the TeraPro cable modem not expressly approved by the cable operator could void the user's authority to operate the unit. There are no user-serviceable parts in the TeraPro cable modem: neither installer nor end user should open the unit; doing so will void the manufacturer's warranty and presents an electrical hazard. Do not place any objects on top of the TeraPro cable modem or power cord, and do not place the unit in direct sunlight. The TeraPro cable modem is designed for horizontal or vertical placement near your computer. Only a trained cable service technician should install the splitter device and connect it to the cable TV.

This equipment has been tested and found to comply with Part 15, Class B of the FCC Rules. These limits are designed to provide reasonable protection against harmful interference in a residential installation. This equipment generates, uses, and can radiate radio frequency energy and, if not installed and used in accordance with the instructions, may cause harmful interference to radio communications. Operation is subject to the following two conditions:

- (1) This device may not cause harmful interference, and
- (2) This device must accept any interference received, including interference that may cause undesired operations.

Please contact your cable service provider if you have questions regarding the TeraPro cable modem, its operation or service.

Copyright 1999 Terayon Communication Systems, Inc. All rights reserved. Terayon, TeraPro, TeraLink and TeraComm are registered trademarks of Terayon Communication Systems, Inc. The Terayon logo and Teralet are trademarks of Terayon Communication Systems, Inc. All other trademarks are the property of their respective owners. All information in this document is accurate as of 11/99. For updated information, check our website at www.terayon.com.



www.terayon.com



Recycled
PN 8500047REV A